







Interruttori e cablaggi

Switches and cordsets

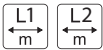
Interruttori Switches		273
Interruttori unipolari a pulsante	<i>Push single pole switches</i>	274
Accessori per interruttori a pulsante	<i>Accessories for press switches</i>	276
Interruttori a bilancere	<i>Rocker switches</i>	277
Interruttori a tirette	<i>Pull switches</i>	279
Interruttori rompifilo	<i>In line cord-switches</i>	280
Interruttori a pedale	<i>Foot switches</i>	281
Cablaggi Cordsets		284
Cablaggi classe II	<i>Class II cordsets</i>	284
Cablaggi Classe I	<i>Class I cordsets</i>	286
Cablaggi Inghilterra	<i>UK cordsets</i>	287
Cablaggi USA	<i>USA cordsets</i>	287

Legenda Simboli

Symbols key

	Lunghezza in metri <i>Lenght in meter</i>
	Imballo <i>Packaging</i>
	Imballo multiplo <i>Multiple packaging</i>
	Peso <i>Weight</i>
	Codice ordinazione Relco <i>Relco order code</i>
	Articoli che, se non disponibili a magazzino, possono richiedere fino a 90 giorni per la consegna. Questi prodotti sono vincolati da una quantità minima ordinabile. <i>For articles which are not in stock, delivery can be up to 90 days. There can be a minimum order acceptable quantity.</i>
	Articoli in promozione fino ad esaurimento scorte. <i>Promotional articles till stock clearance.</i>

Colori

Colors

	Bianco <i>White</i>
	Trasparente <i>Transparent</i>
	Grigio <i>Grey</i>
	Cromo <i>Chrome</i>
	Nero <i>Black</i>
	Paglierino <i>Straw</i>
	Oro <i>Gold</i>
	Verniciato Oro <i>Gold varnished</i>
	Verniciato Bianco <i>White varnished</i>
	Ottone <i>Brass</i>
	Zincato <i>Zinc</i>
	Antico <i>Antique</i>
	Avorio <i>Ivory</i>
	Marrone <i>Brown</i>

Interruttori unipolari a pulsante

Single pole press switches

NORME DI RIFERIMENTO
STANDARD REFERENCE

EN 61058-1 - UL 1054 - CSA C22.2
EN 61058-1 - UL 1054 - CSA C22.2



115N/T125 1[16]A 250V T125/55

Classe II - IP20 - Cat. D - PTI 250 - 1E4 - Contatti in bronzo - Morsetti automatici - Bottone bianco o nero - Grado inquinamento: normale - Modello /i con ranella.

Class II - IP20 - Cat. D - PTI 250 - 1E4 - Bronze contacts - Push in terminals - Black or white button - Pollution degree: normal - /i model with nut.

Codice articolo
Article code

115N/T125/BB	<input type="checkbox"/>	3000	3,7	
● 91	<input type="checkbox"/>	1000 10000	3,7	
115N/T125/i/BB	<input type="checkbox"/>	3000	4,1	
V1001150005 con / with /i	<input type="checkbox"/>	3000	4,1	
115N/T125/N	<input checked="" type="checkbox"/>	3000	3,7	

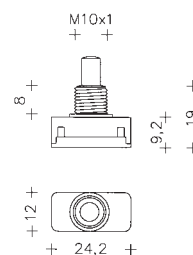

collo / neck 8 mm



115P 1[16]A 250V T125/55

Contatti in bronzo - Morsetti automatici - Bottone bianco o nero - Grado inquinamento: normale - Normalmente chiuso, aperto se premuto

Bronze contacts - Push in terminals - Black or white button - Pollution degree: normal - Normally closed, open if pressed

Codice articolo
Article code

115N/P/T55/BB	<input type="checkbox"/>	3000	3,6	
---------------	--------------------------	------	-----	--

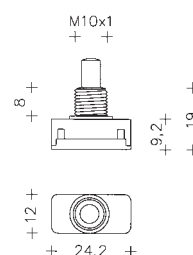

collo / neck 8 mm



135 1[16]A 250V T125/55 136 1[16]A 250V T 125/55

Classe II - IP20 - Cat. D - PTI250 - 1E4 - Contatti in ottone - Morsetti a vite - Bottone bianco o nero - Grado inquinamento: normale - Modello /i con ranella

Class II - IP20 - Cat. D - PTI250 - 1E4 - Brass contacts - Screw terminals - Black or white button - Pollution degree: normal - /i model with nut.

Codice articolo
Article code

135/BB	<input type="checkbox"/>	3000	4,1	
135/N	<input checked="" type="checkbox"/>	3000	4,1	
135/i/BB	<input type="checkbox"/>	3000	5,4	
136/BB	<input type="checkbox"/>	3000	5,0	
136/N	<input checked="" type="checkbox"/>	3000	5,0	

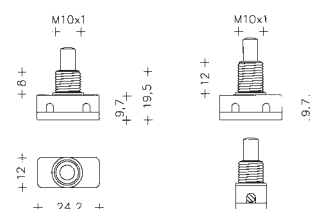

135

collo / neck
8 mm

136

collo / neck
12 mm



1151 2[32]A 250V T125/55 / UR 3A 125V T65
1153 2[32]A 250V T125/55

Classe II - IP20 - Cat. D - PTI250 - 1E4 - Contatti in ottone - Morsetti a vite - Bottone bianco - Grado inquinamento: normale.
 Class II - IP20 - Cat. D - PTI250 - 1E4 - Brass contacts - Screw terminals - White button - Pollution degree: normal.

Codice articolo Article code					
1151/BB	<input type="checkbox"/>	3000	3,7		
1153/BB	<input type="checkbox"/>	3000	4,1		

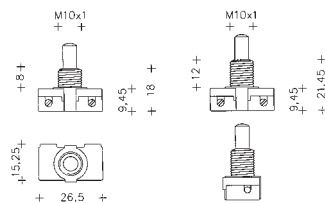

1151
collo / neck 8 mm

1153
collo / neck 12 mm



63 2[32]A 250V T55 / UR 2A 125V T65

Classe II - IP20 - Cat. D - PTI250 - 1E4 - Contatti in lega di ottone - Morsetti a vite - Bottone bianco - Grado inquinamento: normale - Modello /i con ranella.
 Class II - IP20 - Cat. D - PTI250 - 1E4 - Brass alloy contacts - Screw terminals - White button - Pollution degree: normal - /i model with nut.

Codice articolo Article code					
63/BB	<input type="checkbox"/>	3000	3,8		
63/BB+I/BB con / with /i	<input type="checkbox"/>	3000	3,8		
90 con / with /i	<input type="checkbox"/>	200	1000	1,6	
87 con / with /i	<input type="checkbox"/>	200	1000	5,2	

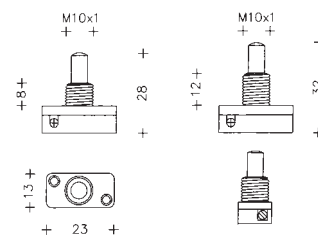

63-90
collo / neck 8 mm

87
collo / neck 12 mm

Codice articolo VLM VLM article code
S/E63/A/B
S/E63/C/B



63/S 2[32]A 250V T55 / UR 2A 125V T65

Classe II - IP20 - Cat. D - PTI250 - 1E4 - Interruttore per circuiti stampati - Contatti in lega di ottone - Bottone bianco - Grado inquinamento: normale.
 Class II - IP20 - Cat. D - PTI250 - 1E4 - Switch for printed boards - Brass alloy contacts - White button - Pollution degree: normal.

Codice articolo Article code					
63/S/LL/BB	<input type="checkbox"/>	3000	3,8		
63/S/LS/BB	<input type="checkbox"/>	3000	3,8		

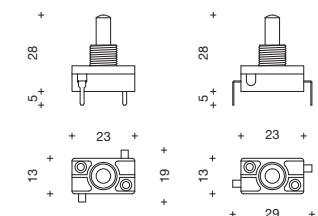

63/S/LL

63/S/LS

Accessori per interruttori a pulsante

Accessories for press switches

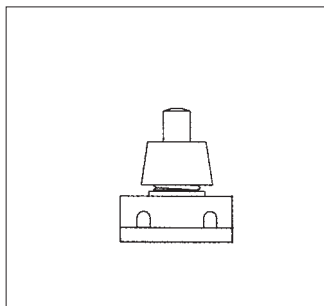
**i**

Bianco, nero - Ranella in plastica per articoli - 115-116, 122, 135-136, 1151- 1153 e 63-63C

White, black - Plastic nut for switches - 115-116, 122, 135-136, 1151- 1153 e 63-63C

Codice articolo
Article code

i/BB

3000



0,7

i/N

3000

0,7

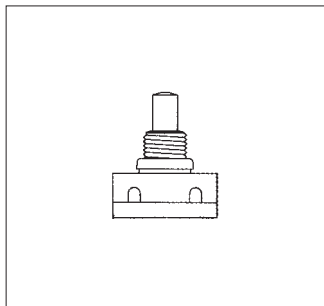
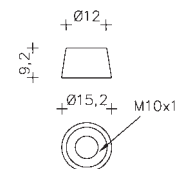
**336**

Ranella in metallo per articoli 115-116, 122, 135-136, 1151- 1153 e 63-63C

Metals nut for switches 115-116, 122, 135-136, 1151- 1153 e 63-63C

Codice articolo
Article code

336/MT

3000

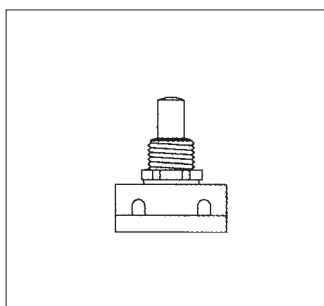
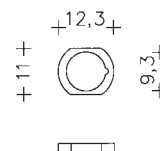

0,2

**303**

Dado esagonale 12 mm in ottone per articoli 115-116, 122, 135-136, 1151- 1153 e 63-63C

12 mm brass exagonal nut for articles 115-116, 122, 135-136, 1151- 1153 e 63-63C

Codice articolo
Article code

303/MT

2000

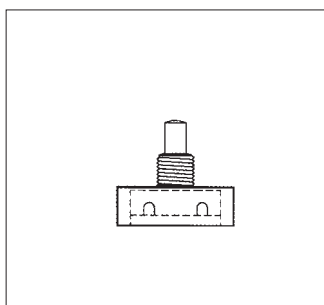
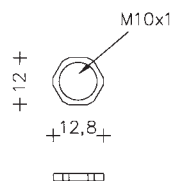

0,9

**330S**

Scatola di protezione per articoli 115-116, 122, 135-136, 1151- 1153 e 63-63C

Insulating cover for articles 115-116, 122, 135-136, 1151- 1153 e 63-63C

Codice articolo
Article code

330S/I

3000

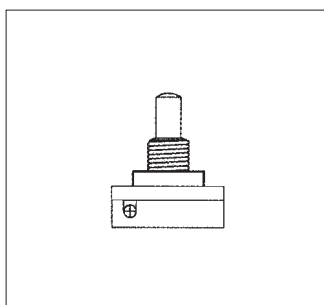
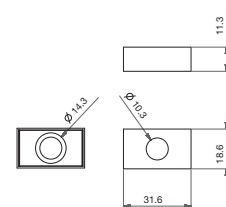

1,1

**E/893**

Rondella in plastica per articoli 115-116, 122, 135-136, 1151- 1153 e 63-63C

Plastic ring for articles 115-116, 122, 135-136, 1151- 1153 e 63-63C

Codice articolo
Article code

E/893/B

3000



0,2

E/893/N

3000

0,2

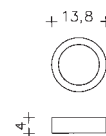

Interruttori a bilancere

Rocker switches

NORME DI RIFERIMENTO
STANDARD REFERENCE

EN 61058-1 - UL 1054 - CSA C22.2
EN 61058-1 - UL 1054 - CSA C22.2



144 2(1)A 250V T125/55 UR: 2A 125V T85

Contatti in ottone - Morsetti a vite.
Brass contacts - Screw terminals.

Codice articolo
Article code

Articolo	Colore	3000	500	4,5	Icone	Certificazioni
144/BB	White	3000		4,5	[Hand icon] [Box icon] [Weight icon]	C RU US
● 84-B	White	100	500	4,5		C RU US
144/GR	Grey	3000		4,5		C RU US ●
144/N	Black	3000		4,5		C RU US
● 84	Black	100	500	4,5		C RU US
144/P	Yellow	3000		4,5		C RU US ●
● 84-O	Yellow	100	500	4,5		C RU US ●

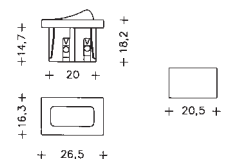

346

Molletta di fissaggio per art. 144.
Securing plate for art. 144.

Codice articolo
Article code

346/MT	Grey	3000		0,6	[Hand icon] [Box icon] [Weight icon]	
--------	------	------	--	-----	--------------------------------------	--

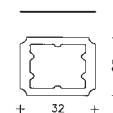

145 1(1)A 250V T140/55 - UR: 2A 125V T65

Classe II - IP00 - Cat. D - PTI250 - 1E4 - Unipolare - Contatti in bronzo - Fissaggio con viti - Grado d'inquinamento: normale - Bottone bianco o nero.

Class II - IP00 - Cat. D - PTI250 - 1E4 - Single pole - Bronze contacts - Clamping by screws - Pollution degree: normal - White or black button.

Codice articolo
Article code

145/BB	White	3000		3,5	[Hand icon] [Box icon] [Weight icon]	RU ●
145/N	Black	3000		3,5		RU ●
145/R	Red	3000		3,5		RU ●

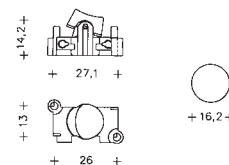

145/C 1(1)A 250V T140/55 UR: 2A 125V T65

Classe II - IP00 - Cat. D - PTI250 - 1E4 - Unipolare - Contatti in bronzo - Fissaggio a scatto - Grado d'inquinamento: normale - Bottone bianco o nero.

Class II - IP00 - Cat. D - PTI250 - 1E4 - Single pole - Bronze contacts - Push fit - Pollution degree: normal - White or black button.

Codice articolo
Article code

145/C/BB	White	3000		3,5	[Hand icon] [Box icon] [Weight icon]	RU ●
145/C/N	Black	3000		3,5		RU ●
145/GH/N	Black	3000		0,4		RU ●

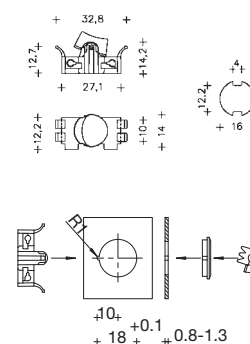



1150 2[32]A 250V T125/55 UR: 3A 125V T65

Classe II - IP20 - Cat. D - PTI250 - 1E4 - Contatti in ottone - Morsetti a vite - Grado d'inquinamento: normale - Colori: bianco, nero.

Class II - IP20 - Cat. D - PTI250 - 1E4 - Brass contacts - Screw terminals - Pollution degree: normal - Colours: white, black.

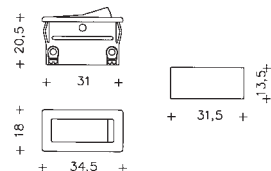

Codice articolo
Article code

1150/BB		1000	8,7		
1150/N		1000	8,7		



125 2[32]A 250V T125/55 UR: 3A 125V T65

Classe II - IP20 - Cat. D - PTI250 - 1E4 - Contatti a aggaffare in ottone - Grado d'inquinamento: normale - Bottone: bianco, nero, marrone, rosso.

Class II - IP20 - Cat. D - PTI250 - 1E4 - Brass crimp terminals - Pollution degree: normal - White, black, red, brown button.

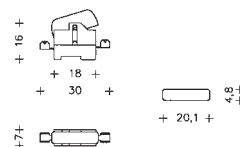

Codice articolo
Article code

125/BB		2000	2,1		
125/N		2000	2,1		
125/M		2000	2,1		
125/I		2000	2,1		



389

Scatola per doppio isolamento per art. 125.
Insulating cover for art. 125.

Codice articolo
Article code

389/I		2000	2,3	
-------	--	------	-----	--

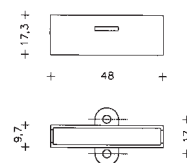

Interruttori a tirette

Pull switches

NORME DI RIFERIMENTO
STANDARD REFERENCE

EN 61058-1 - UL 1054 - CSA C22.2
EN 61058-1 - UL 1054 - CSA C22.2



200 2A dc/ac-1[16]A-250V-T125 / UR: 2A 125V T65

Cl. II - Cat. D - PTI250 - 1E4 - Unipolare - Contatti in ottone - Cordicella e pomolino bianchi 25cm - Grado d'inquinamento: normale.

Cl. II - Cat. D - PTI250 - 1E4 - Single pole - Brass contacts - 25cm white cord and toggle - Pollution degree: normal.

Codice articolo
Article code



200/N/B	con / with cord.	<input type="checkbox"/>	1000	6,7	
S/200/B	con / with cord.	<input type="checkbox"/>	100	6,7	
200/S/N	senza / without cord.	<input checked="" type="checkbox"/>	1000	6,7	
200/PM+COR/B	cord.25 cm	<input type="checkbox"/>	10000	0,2	

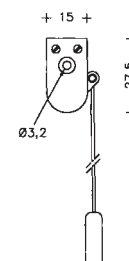

388

Scatola per doppio isolamento per art. 200.
Insulating cover for art. 200.

Codice articolo
Article code



388/B		<input type="checkbox"/>	1000	1,4	
--------------	--	--------------------------	------	-----	--



200/327 2A dc/ac-1[16]A-250V-T125 / UR: 2A 125V T65

Completo di piastrina - Con due fori di fissaggio.
With mounting plate - Two fixing holes.

Codice articolo
Article code



200/327/B		<input type="checkbox"/>	1000	8,3	
327/MT	squadr. / bracket	<input checked="" type="checkbox"/>	1000	2,5	

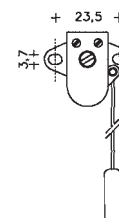

200/328 2A dc/ac-1[16]A-250V-T125 / UR: 2A 125V T65

Completo di piastrina - Con un foro di fissaggio.
With mounting plate - One fixing hole.

Codice articolo
Article code



200/328/B		<input type="checkbox"/>	1000	8,5	
328/MT	squadr. / bracket	<input checked="" type="checkbox"/>	1000	2,5	





E/615 1[16]A 250V T55

Cl II - Cat. D - PTI250 - 1E4 - Unipolare - Contatti in ottone - Cordicella e pomolino bianco lunghezza 25 cm, 615/100 100cm - Grado di inquinamento: normale.

Cl. II - Cat. D - PTI250 - 1E4 - Single pole - Brass contacts - White cord and toggle lenght 25cm; 615/100 100 cm - Pollution degree: normal.

Codice articolo
Article code

615/BB	<input type="checkbox"/>	2000	4,2		
S/E615/B	<input type="checkbox"/>	200	4,2		
615/100/BB	<input type="checkbox"/>	2000	6,0		

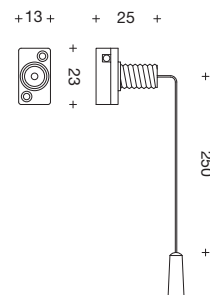

Interruttori rompifilo In line cord-switches

NORME DI RIFERIMENTO
STANDARD REFERENCE

EN 61058-1 - UL 20 - CSA C22.2
EN 61058-1 - UL 20 - CSA C22.2



450 1[16]A 250V T55

IP40 - PTI250 - 1E4 - A cursore - Contatti in ottone - Morsetti a vite - Chiusura con viti - Per cavo H03VVH2-F - 2 x 0.75 mm² - Con morsetto passante.

IP40 - PTI250 - 1E4 - Slide switch - Brass contacts - Screw terminals - Screw closed case - For flat H03VVH2-F - 2 x 0.75 mm² - Connection for neutral.

Codice articolo
Article code

S/450/B	<input type="checkbox"/>	100	8,0		
S/450/N	<input checked="" type="checkbox"/>	100	8,0		
S/450/O	<input type="checkbox"/>	100	8,0		
S/450/I	<input checked="" type="checkbox"/>	100	8,0		
DD/450/BB	<input type="checkbox"/>	1000	8,0		
DD/450/N	<input checked="" type="checkbox"/>	1000	8,0		
DD/450/O	<input type="checkbox"/>	1000	8,0		

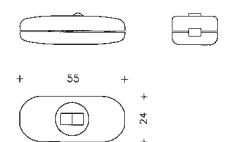

Design by Achille e
Pier Giacomo Castiglioni



475 2A 125V T85

A cursore - Contatti in ottone - Morsetti a perforazione - Chiusura con viti - Per cavo SPT1.

Slide switch - Brass contacts - Piercing terminals - Screw closed case - For SPT1 cable.

Codice articolo
Article code

D/475/BB	<input type="checkbox"/>	1000	20,0
D/475/N	<input checked="" type="checkbox"/>	1000	20,0

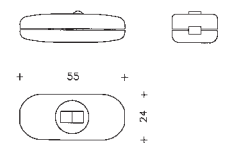

Design by Achille e
Pier Giacomo Castiglioni



475/2 2A 125V T85

A cursore - Contatti in ottone - Morsetti a perforazione - Chiusura con viti - Per cavo SPT1 e SPT2.

Slide switch - Brass contacts - Piercing terminals - Screw closed case - For SPT1 e SPT2 cable.

Codice articolo
Article code

Codice articolo Article code		1000	20,0	C ^{RU} US
D/475/2/BB		1000	20,0	C ^{RU} US
D/475/2/N		1000	20,0	C ^{RU} US

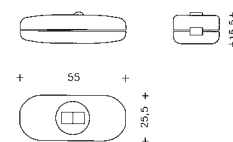

Design by Achille e
Pier Giacomo Castiglioni



478 1[16]A 250V T 55 UR: 2A 125V T85

IP20 - PT1250 - 1E4 - Abilancere - Contatti in ottone - Morsetti a vite - Chiusura a scatto - Con due morsetti passanti - Approvato UR.

IP20 - PT1250 - 1E4 - Rocker switch - Brass contacts - Screw terminals - Clip together case - With connection for neutral and earth - UR approved.

Codice articolo
Article code

Codice articolo Article code		100	1000	16,0	C ^{RU} US	Codice articolo VLM VLM article code
● 92-B		100	1000	16,0	C ^{RU} US	S/478/B
● 92		100	1000	16,0	C ^{RU} US	S/478/N
● 92-O		100	1000	16,0	C ^{RU} US	S/478/P
D/478/BB		500		16,0	C ^{RU} US	
D/478/N		500		16,0	C ^{RU} US	
D/478/P		500		16,0	C ^{RU} US	
D/478/M		500		16,0	C ^{RU} US	●

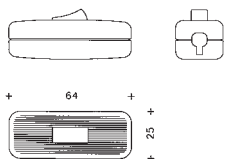

Interruttori a pedale Foot switches

NORME DI RIFERIMENTO
STANDARD REFERENCE

EN 61058-1 - CSA C 22.2 - UL 20
EN 61058-1 - CSA C 22.2 - UL 20



555 2A 125V T65

Chiusura con viti - Per cavi spt2.

Screw closed case - For spt2 cables.

Codice articolo
Article code

Codice articolo Article code		200	55,0	C ^{RU} US
555/2/BB		200	55,0	C ^{RU} US
555/2/N		200	55,0	C ^{RU} US
D/555/2/BB		200	55,0	C ^{RU} US
D/555/2/N		200	55,0	C ^{RU} US

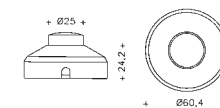

Design by Achille e
Pier Giacomo Castiglioni



565 2[32]A 250V / UR: 2A 125V T65

IP40 - PTI250 - 1E4 - Chiusura a scatto - Cavo bipolare o tripolare - Con due morsetti passanti - Approvato jet.

IP40 - PTI250 - 1E4 - Clip together case - For two or three core cable - With connection for neutral and for earth - jet approved.

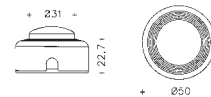

Codice articolo Article code						Codice articolo VLM VLM article code
● 96-B	<input type="checkbox"/>	100	1000	28,0		S/565/B
S/565/I	<input checked="" type="checkbox"/>	100		28,0		
● 96	<input checked="" type="checkbox"/>	100	1000	28,0		S/565/N
● 96-O	<input checked="" type="checkbox"/>	100	1000	28,0		S/565/P
D/565/BB	<input type="checkbox"/>	500		28,0		
D/565/I	<input checked="" type="checkbox"/>	500		28,0		
D/565/N	<input checked="" type="checkbox"/>	500		28,0		
D/565/P	<input checked="" type="checkbox"/>	500		28,0		



146 2[32]A 250V T55

IP20 - PTI175 - 1E4 - Chiusura con viti - Cavo bipolare.

IP20 - PTI175 - 1E4 - Screw closed case - For two core cable.

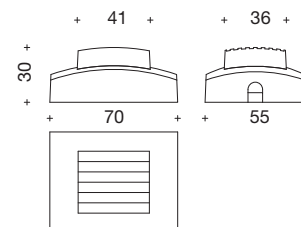

Codice articolo Article code				
S/E146/B	<input type="checkbox"/>	25	60,0	●
S/E146/N	<input checked="" type="checkbox"/>	25	60,0	●
S/E146/O	<input checked="" type="checkbox"/>	25	60,0	●



D/661 2[32]A 250V T55

Chiusura con viti - Cavo bipolare o tripolare - Per cavi SPT1 e SPT2 - Con due morsetti passanti.

Screw closed case - For two or three core cable - With connection for neutral and for earth - For SPT1 and SPT2 cables.

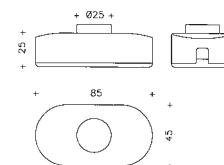

Codice articolo Article code				
D/661/N	<input checked="" type="checkbox"/>	200	67,5	

Design by Achille e Pier Giacomo Castiglioni



D/662 2X2[2]A 250V T55

Tastiera per doppia accensione - Chiusura con viti - Con morsetto passante.

Double single pole foot switch - Screw closed case - With connection for neutral.

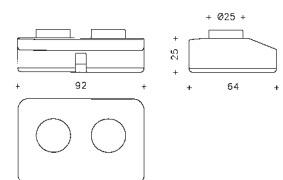

Codice articolo Article code				
D/662/N	<input checked="" type="checkbox"/>	100	92,0	

Design by Achille e Pier Giacomo Castiglioni

Qualità del progetto a firma di Achille e Pier Giacomo Castiglioni

Quality of project by Achille e Pier Giacomo Castiglioni

Qualità del prodotto *Quality of product*
garantita da *guaranteed by*



Rompifilo 450 e 475/2 per filo unipolare
a cursore ad uso universale.

Materiale: termoplastico.

Colori: bianco, nero.

450 and 475/2 single pole slide
inline switch.

Thermoplastic material.

Colours: white, black



www.achillecastiglioni.it

Cablaggi classe II

Class II cordsets



C/63

Cablaggio con: spina bipolare europea 1063 (2,5A 250V) e cavo piatto 2x0,75 mm² H03VVH2-F.

Cordset with: double pole Euro-plug 1063 (2,5A 250V) and flat cable 2x0,75 mm² H03VVH2-F.

Codice articolo Article code	L1 m				
CB/63/15*22	1,5	<input type="checkbox"/>	250	56,8	
CB/63/20*22	2	<input type="checkbox"/>	250	79,0	
CB/63/30*22	3	<input type="checkbox"/>	200	115,0	
CN/63/15*22	1,5	<input checked="" type="checkbox"/>	250	56,8	
CN/63/20*22	2	<input checked="" type="checkbox"/>	250	79,0	
CN/63/30*22	3	<input checked="" type="checkbox"/>	200	115,0	
CII/63/15*22P	1,5	<input checked="" type="checkbox"/>	250	56,8	
CII/63/20*22P	2	<input checked="" type="checkbox"/>	250	79,0	
CII/63/30*22P	3	<input checked="" type="checkbox"/>	200	115,0	

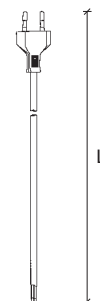

C/6322

Cablaggio con:
spina bipolare europea 1063 (2,5A 250V);
rompifilo unipolare a cursore 422 (2[32]A - 250V - T55 - IP40 - PTI250 - 1E4);
cavo piatto 2x0,75 mm² H03VVH2-F.

*Cordset with:
double pole Euro-plug 1063 (2,5A 250V);
in-line single pole slide switch 422 (2[32]A - 250V - T55 - IP40 - PTI250 - 1E4);
flat cable 2x0,75 mm² H03VVH2-F.*

Codice articolo Article code	L1 m	L2 m				
CB/6322/8/4*22 V3003220053	0,8	0,4	<input type="checkbox"/>	250	60,8	
CB/6322/10/5*22 V3003220013	1	0,5	<input type="checkbox"/>	250	65,6	
CB/6322/10/7*22 V3003220016	1	0,7	<input type="checkbox"/>	250	72,0	
CB/6322/12/8*22 V3003220023	1,2	0,8	<input type="checkbox"/>	250	80,8	
CN/6322/10/5*22 V3003220078	1	0,5	<input checked="" type="checkbox"/>	250	65,6	
CN/6322/10/7*22 V3003220085	1	0,7	<input checked="" type="checkbox"/>	250	72,0	
CN/6322/12/8*22 V3003220101	1,2	0,8	<input checked="" type="checkbox"/>	250	80,8	
CO/6322/10/5*22 V3003220176	1	0,5	<input checked="" type="checkbox"/>	250	65,6	
CO/6322/10/7*22 V3003220179	1	0,7	<input checked="" type="checkbox"/>	250	72,0	
CO/6322/12/8*22 V3003220196	1,2	0,8	<input checked="" type="checkbox"/>	250	80,8	

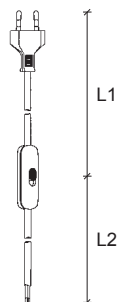

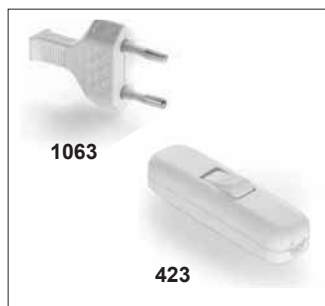

C/6323

Cablaggio con:
 spina bipolare europea 1063 (2,5A 250V);
 rompifilo unipolare a bilancere 423 (2[32]A - 250V - T55 - IP40 - PTI250 - 1E4);
 cavo piatto 2x0,75 mm² H03VVH2-F.

Cordset with:
 double pole Euro-plug 1063 (2,5A 250V);
 in-line single pole rocker switch 423 (2[32]A - 250V - T55 - IP40 - PTI250 - 1E4);
 flat cable 2x0,75 mm² H03VVH2-F.

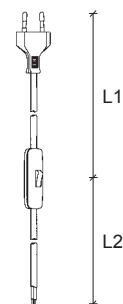

Codice articolo Article code	L1 m	L2 m				Codice articolo VLM VLM article code	
CB/6323/8/4*22 V3003230128	0,8	0,4	□	250	60,8		
CB/6323/10/5*22 V3003230008	1	0,5	□	250	65,6		
● 93-B	1	0,5	□	50	250	65,6	S/CB/6323/10/5*22
CB/6323/12/8*22 V3003230026	1,2	0,8	□	250	80,8		
● 94-B	1,2	0,8	□	50	200	80,8	S/CB/6323/12/8*22
CN/6323/10/5*22 V3003230205	1	0,5	■	250	65,6		
● 93	1	0,5	■	50	250	65,6	S/CN/6323/10/5*22
CN/6323/12/8*22 V3003230248	1,2	0,8	■	250	80,8		
● 94	1,2	0,8	■	50	200	80,8	S/CN/6323/12/8*22
CP/6323/10/5*22 V3003230378	1	0,5	■	250	65,6		
● 93-O	1	0,5	■	50	250	65,6	S/CP/6323/10/5*22
CP/6323/12/8*22 V3003230397	1,2	0,8	■	250	80,8		
● 94-O	1,2	0,8	■	50	200	80,8	S/CP/6323/12/8*22
CM/6323/12/8*22 V3003230187	1,2	0,8	■	250	80,8		
CII/6323/10/5*22P V3003230148	1	0,5	⊗	250	65,6	⊗	
S/CII/6323/10/5*22P V3003230448	1	0,5	⊗	50	65,6	⊗	
CII/6323/12/8*22P V3003230158	1,2	0,8	⊗	250	80,8	⊗	
S/CII/6323/12/8*22P V3003230449	1,2	0,8	⊗	50	80,8	⊗	



C/6365

Cablaggio con:
 spina bipolare europea 1063 (2,5A 250V);
 interruttore unipolare a pedale 565/C (2[32]A - 250V - Class II - IP40 - PTI250 - 1E4);
 cavo piatto 2x0,75 mm² H03VVH2-F.

Cordset with:
 double pole Euro-plug 1063 (2,5A 250V);
 single pole foot switch 565/C (2[2]A - 250V - Class II - IP40 - PTI250 - 1E4);
 flat cable 2x0,75 mm² H03VVH2-F.

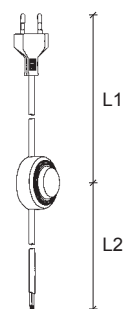

Codice articolo Article code	L1 m	L2 m				
CN/6365C/15/25 V3003650069	1,5	2,5	■	100	165,0	
CII/6365/15/25 V3003650030	1,5	2,5	■	100	165,0	
● 97	1,5	2,5	■	25	150	165,0
● 97-B	1,5	2,5	□	25	150	165,0
● 97-O	1,5	2,5	■	25	150	165,0



C/6399

Cablaggio con:

spina bipolare europea 1063 (2,5A 250V);
Rompifilo unipolare "due luci" 499;
cavo 2x0,75 mm² H03VV-F (lato spina), cavo 3x0,75 mm²
H03VV-F (lato libero).

Cordset with:

*double pole Euro-plug 1063 (2,5A 250V);
In-line single pole rocker switch "two lights";
cable 2x0,75 mm² H03VV-F (plug side), cable 3x0,75 mm²
H03VV-F (free end).*

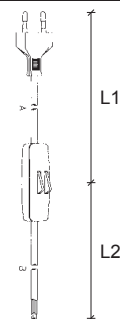

Codice articolo Article code	L1 m	L2 m					
CB/6399/12/8	1,2	0,8		100	120,0		
CN/6399/12/8	1,2	0,8		100	120,0		

Cablaggi Classe I Class I cordsets



C/8239

Cablaggio con:

spina sagomata con terra FRANCO-SCHUKO 1082 (10-16A
250V);
rompifilo bipolare a bilancere più terra 439 (2[32]A - 250V);
cavo tondo 3x0,75 mm² H03VV-F.

Cordset with:

*FRENCH-SCHUKO plug 1082 (10-16A 250V);
in-line double pole rocker switch 439 (2[32]A - 250V);
round cable 3x0,75 mm² H03VV-F.*

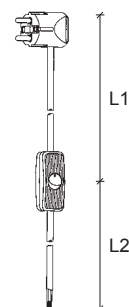

Codice articolo Article code	L1 m	L2 m					
CN/8239/12/8	1,2	0,8		100	149,0		



C/8265

Cablaggio con:

spina sagomata con terra FRANCO-SCHUKO 1082 (10-16A
250V);
interruttore unipolare a pedale 565/C (2[32]A - 250V - Class II -
IP40 - PTI250 - 1E4);
cavo tondo 3x0,75 mm² H03VV-F.

Cordset with:

*FRENCH-SCHUKO plug 1082 (10-16A 250V);
single pole foot switch 565/C (2[32]A - 250V - Class II - IP40 -
PTI250 - 1E4);
round cable 3x0,75 mm² H03VV-F.*

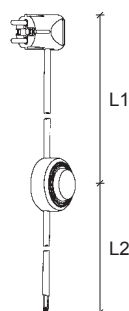

Codice articolo Article code	L1 m	L2 m					
CN/8265C/15/25 V3002650014	1,5	2,5		100	255,0		

Cablaggi Inghilterra UK cordsets



C/8323

Cablaggio con:
spina bipolare UK 1083 (3A 250V);
rompifilo unipolare a bilancere 423 (2[32]A - 250V - T55 - IP40
- PTI250 - 1E4);
cavo piatto 2x0,75 mm² H03VVH2-F.

Cordset with:
double pole UK 1083 (3A 250V);
in-line single pole rocker switch 423 (2[32]A - 250V - T55 - IP40
- PTI250 - 1E4);
flat cable 2x0,75 mm² H03VVH2-F.

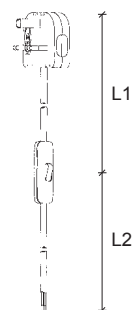

Codice articolo Article code	L1 m	L2 m					
CB/8323/12/8	1,2	0,8		100	107,0		
CN/8323/12/8	1,2	0,8		100	107,0		

Cablaggi USA USA cordsets



C/3075

Cablaggio con:
spina USA 1030/2 (10A 125V) approvata UR;
rompifilo unipolare a cursore 475/2 (2A - 125V) approvato UR;
cavo SPT-2 T105 AWG 18 approvato UR.

Cordset with:
USA plug 1030/2 (10A 125V) UR approved;
in-line single pole slide switch 475/2 (2A - 125V) UR approved;
SPT-2 T105 AWG 18 cable UR approved.

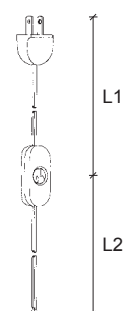

Codice articolo Article code	L1 m	L2 m					
CB/3075/12/8/2 V3000750004	1,2	0,8		250	96,0		
CN/3075/12/8/2 V3000750009	1,2	0,8		250	96,0		

Metteresti un termosifone nel tuo frigorifero?

Would you put a radiator inside your refrigerator?

**Utilizzando lampade ad incandescenza e alogene scaldi...
più scaldi e più consumi energia, e più paghi!**

*When you use incandescent lamps or halogen lamps you are producing heat...
the more heat you produce, the more energy you consume — and the more you pay!*

Spazi commerciali, negozi, ambienti di spettacolo ed anche residenziali sono climatizzati per gran parte dell'anno. Il calore emesso dalle lampade ad incandescenza o alogene deve anch'esso essere smaltito con un notevole spreco energetico.

Commercial spaces, shops, entertainment halls and even homes use air conditioning almost all year round. The heat emitted by incandescent or halogen lamps needs to be dissipated too, and that requires a lot of energy.



La soluzione? ballast elettronici e sistemi LED VLM

Prodotti ad alto contenuto tecnologico che coniugano le esigenze del risparmio energetico ai bisogni estetici, di design e decorativi. Tutti pienamente in linea ai principi contenuti nella direttiva europea 2002/91/EC in applicazione dal 4 gennaio 2006 che limita fortemente per le abitazioni l'uso di energia elettrica destinata all'illuminazione.

The solution? electronic ballasts and VLM LED systems

Products with high technological content that combine energy savings with aesthetics and attractive design. All fully compliant with European Directive 2002/91/EC, in force from 4 January 2006, which sets strong limitations on the use of electric power for home lighting.

